



21 January 2022

Your ref  
ps/jos008-0002

Our ref  
NT396791 /OC/203

HM Land Registry  
Durham Office  
PO Box 75  
Gloucester  
GL14 9BD

DX 321601 Gloucester 33  
Tel 0300 006 0010  
Fax NA  
Email [durham.office@landregistry.gov.uk](mailto:durham.office@landregistry.gov.uk)  
[www.gov.uk/land-registry](http://www.gov.uk/land-registry)

## Official copy/copies

**HM Land Registry payment ref** 21/01 ZONE1YTZ

**Fee debited** £6.00

The official copy/copies of the document(s) you applied for is/are enclosed.

Please contact the HM Land Registry Office named if you have any questions about the enclosed official copy/copies.

ps/jos008-0002

BEIGHTON SINGH LIMITED  
ROYAL BUILDINGS  
VICTORIA STREET  
DERBY  
DE1 1ES







## Official copy of register of title

Title number NT396791

Edition date 14.08.2018

- This official copy shows the entries in the register of title on 20 January 2022 at 18:34:36.
- This date must be quoted as the "search from date" in any official search application based on this copy.
- The date at the beginning of an entry is the date on which the entry was made in the register.
- Issued on 21 January 2022.
- Under s.67 of the Land Registration Act 2002, this copy is admissible in evidence to the same extent as the original.
- For information about the register of title, see [www.gov.uk/land-registry](http://www.gov.uk/land-registry).
- This title is dealt with by HM Land Registry Durham Office.

### A: Property register

This register describes the land and estate comprised in the title.

#### CITY OF NOTTINGHAM

- 1 (21.06.2004) The Freehold land shown edged with red on the plan of the above title filed at the Registry and being The New Alexandra Court, Woodborough Road, Nottingham (NG3 4LN).
- 2 (21.06.2004) The land has the benefit of the rights granted by but is subject to the rights reserved by a Transfer of the land in this title dated 10 June 2004 made between (1) Nottingham City Council and (2) James Roger Carlton.

*NOTE: Original filed.*

### B: Proprietorship register

This register specifies the class of title and identifies the owner. It contains any entries that affect the right of disposal.

#### Title absolute

- 1 (04.03.2008) PROPRIETOR: [REDACTED]
- 2 (04.03.2008) The price stated to have been paid on 12 November 2007 was £250,000.
- 3 (04.03.2008) RESTRICTION: No disposition of the registered estate by the proprietor of the registered estate, or by the proprietor of any future registered charge, is to be registered without a written consent signed by the proprietor for the time being of the Charge dated 17 January 2008 in





## B: Proprietorship register continued

favour of The Royal Bank Of Scotland Plc referred to in the Charges Register.

- 4 (27.01.2017) Alexandra Court (Nottingham) RTM Company Limited of 9 Nelson Road, Beeston Nottingham, NG9 1LF has lodged evidence under rule 79A of the Land Registration Rules 2003 that it is a RTM company and has acquired the right to manage the land in this title pursuant to Chapter 1 of Part 2 of the Commonhold and Leasehold Reform Act 2002.

## C: Charges register

This register contains any charges and other matters that affect the land.

- 1 (22.07.2005) The parts of the land affected thereby are subject to the leases set out in the schedule of leases hereto.  
The leases grant and reserve easements as therein mentioned.

NOTE: Each lease is referenced by edging and numbering in blue on the title plan unless otherwise stated in the schedule of leases.

- 2 (04.03.2008) REGISTERED CHARGE dated 17 January 2008.

- 3 (26.07.2018) Proprietor: THE ROYAL BANK OF SCOTLAND PLC (Scot. Co. Regn. No. SC083026) of Ayr Office PO Box 17, 30 Sandgate, Ayr KA7 1BY and of 36 St Andrews Square, Edinburgh EH2 2YB.

- 4 (06.03.2008) The land tinted brown on the title plan is subject to the following rights granted by a Conveyance of other land dated 21 October 1993 made between (1) Nottingham City Council (Vendor) and (2) Stuart Mills (Purchaser):-

"TOGETHER with a right of way on foot only over and along so much of the Vendors retained land as is coloured brown on the said plan

AND TOGETHER with the benefit of but SUBJECT to all such rights easements or quasi easements exercised by and between the property hereby conveyed and the adjoining land of the Vendor and which but for unity of tenure would have been easements."

NOTE: The land coloured brown referred to is tinted brown on the title plan.

- 5 (14.08.2018) The parts of the land thereby affected are subject to the rights granted by a Lease of Cell Site NOT0072 dated 10 August 2018 referred to in the schedule of leases hereto.

The said deed also contains restrictive covenants by the grantor.

NOTE: Copy lease filed under NT540683.

## Schedule of notices of leases

	Registration date and plan ref.	Property description	Date of lease and term	Lessee's title
1	22.07.2005 1 and 2	Apartment 57 (fourth floor) and car parking space (lower parking level)	08.07.2005 999 years from 1.6.2005	NT409892

## Schedule of notices of leases continued

	Registration date and plan ref.	Property description	Date of lease and term	Lessee's title
2	23.08.2005 3 and 4	Apartment 35 (second floor) and Car Parking space (basement level)	28.07.2005 999 years from 1.6.2005	NT410951
3	26.08.2005 5 and 6	Apartment 59 (fourth floor) and car parking space (lower parking level)	28.07.2005 999 years from 1.6.2005	NT411101
4	08.09.2005 7 and 8	Apartment 14 (ground floor) and car parking space (basement level)	08.07.2005 999 years from 1.6.2005	NT411431
5	05.10.2005 11 and 12	Apartment 68 (second floor) and car parking space (lower parking level)	28.07.2005 999 years from 1.6.2005	NT412363
6	06.10.2005 13	Apartment 5 (basement level) and car parking space (basement level)	16.09.2005 999 years from 1.6.2005	NT412396
7	03.10.2005 14 & 15	Apartment 56 (fourth floor) & parking space (basement level)	22.07.2005 999 years from 1.6.2005	NT412261
8	12.10.2005 16 and 17	Apartment 29 (second floor) and parking space (basement level)	17.08.2005 999 years from 1.6.2005	NT412603
9	12.10.2005 18 and 19	Apartment 67 (fifth floor) and parking space (lower parking level)	12.08.2005 999 years from 1.6.2005	NT412604
10	20.10.2005 20 and 21	Apartment 25, (first floor) and car parking space (basement level)	15.09.2005 999 years from 1.6.2005	NT412870
11	20.12.2005 22 and 23	Apartment 24, (first floor) and car parking space (basement level)	22.11.2005 999 years from 1.6.2005	NT414925
12	24.01.2006 24 and 25	Apartment 37 (second floor) and car parking space (basement level)	03.01.2006 999 years from 1.6.2005	NT416109
13	28.03.2006 26 and 27	Apartment 36 (second floor) and car parking space (basement level)	23.02.2006 999 years from 1.6.2005	NT418320
14	24.07.2006 32 and 33	Apartment 33 (second floor) and parking space (basement level)	15.06.2006 999 years from 1.6.2005	NT422263
15	25.07.2006 34 and 35	Apartment 58 (fourth floor) and parking space (lower parking level)	19.06.2006 999 years from 1.6.2005	NT422333
16	26.07.2006 36 and 37	Apartment 44 Alexandra Court (third floor) and parking space (basement level)	20.06.2006 999 years from 1.6.2005	NT422391

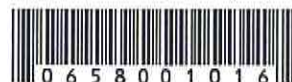



## Schedule of notices of leases continued

	Registration date and plan ref.	Property description	Date of lease and term	Lessee's title
17	26.07.2006 38 and 39	Apartment 55 (fourth floor) and parking space (basement level)	12.06.2006 999 years from 1.6.2005	NT422392
18	26.07.2006 40 and 41	Apartment 47 (third floor) and parking space (basement level)	15.06.2006 999 years from 1.6.2005	NT422393
19	26.07.2006 42 and 43	Apartment 26 (first floor) and parking space (basement level)	14.06.2006 999 years from 1.6.2005	NT422394
20	27.07.2006 44 and 45	Apartment 46 (third floor) and parking space (basement level)	05.05.2006 999 years from 1.5.2005	NT422446
21	06.06.2006 28 and 29	Apartment 6 and car parking space (basement level)	15.05.2006 999 years from 1.6.2005	NT420504
22	31.08.2006 46 and 47	Apartment 8 (Ground floor) and parking space	03.08.2006 999 years from 1.6.2005	NT423641
23	31.08.2006 48 and 49	Apartment 64 (Fifth floor) and parking space (lower parking level)	03.08.2006 999 years from 1.6.2005	NT423642
24	04.09.2006 50 and 51	Apartment 22 (First floor) and parking space	13.06.2006 999 years from 1.6.2005	NT423745
25	07.09.2006 52 and 53	Apartment 60 (Fourth floor) and parking space (lower parking level)	11.08.2006 999 years from 1.6.2005	NT423917
26	07.09.2006 54 and 55	Apartment 21 (First floor) and parking space	11.08.2006 999 years from 1.6.2005	NT423926
27	11.09.2006 56 and 57	Apartment 65 (Fifth floor) and parking space (lower level parking)	03.08.2006 999 years from 1.6.2005	NT424066
28	12.09.2006 58 and 59	Apartment 63 (Fifth floor) and parking space (lower level parking)	03.08.2006 999 years from 1.6.2005	NT424105
29	13.09.2006 60 and 61	Apartment 3 (Basement) and parking space	18.08.2006 999 years from 1.6.2005	NT424150
30	13.09.2006 62 and 63	Apartment 17 (Ground Floor) and parking space	04.08.2006 999 years from 1.6.2005	NT424153
31	18.09.2006 64 and 65	Apartment 54 (Fourth floor) and parking space	18.08.2006 999 years from 1.6.2005	NT424294

## Schedule of notices of leases continued

	Registration date and plan ref.	Property description	Date of lease and term	Lessee's title
32	18.09.2006 66 and 67	Apartment 48 (Third floor) and parking space	14.06.2006 999 years from 1.6.2005	NT424302
33	25.09.2006 68 and 69	Apartment 52 (fourth floor) and parking space	03.07.2006 999 years from 1.6.2005	NT424540
34	27.09.2006 70 and 71	Apartment 13 (Ground floor) and parking space	15.08.2006 999 years from 1.6.2005	NT424647
35	27.09.2006 72 and 73	Apartment 45 (Third floor) and parking space (Basement level)	09.06.2006 999 years from 1.6.2005	NT424649
36	04.10.2006 74 and 75	Apartment 16 (ground floor) and parking space	14.08.2006 999 years from 1.6.2005	NT424945
37	25.10.2006 78 and 79	Apartment 69 (fifth floor) and parking space (lower parking level)	28.07.2006 999 years from 01.06.2005	NT425724
38	25.10.2006 80 and 81	Apartment 70 (fifth floor) and parking space	01.08.2006 999 years from 01.06.2005	NT425725
39	25.10.2006 82 and 83	Apartment 66 (fifth floor) and parking space (lower parking level)	28.07.2006 999 years from 01.06.2005	NT425726
40	26.10.2006 84 and 85	Apartment 27 (first floor) and parking space	18.08.2006 999 years from 01.06.2005	NT425772
41	26.10.2006 86 and 87	Apartment 34 (second floor) and parking space	03.08.2006 999 years from 01.08.2006	NT425773
42	26.10.2006 88 and 89	Apartment 28 (first floor) and parking space	02.08.2006 999 years from 01.06.2005	NT425774
43	26.10.2006 90 and 91	Apartment 20 (first floor) and parking space	03.08.2006 999 years from 01.06.2005	NT425775
44	26.10.2006 92 and 93	Apartment 23 (first floor) and parking space	01.08.2006 999 years from 01.06.2005	NT425776
45	26.10.2006 94 and 95	Apartment 39 (second floor) and parking space (basement level)	01.08.2006 999 years from 01.06.2005	NT425777
46	26.10.2006 96 and 97	Apartment 49 (third floor) and parking space	04.08.2006 999 years from 01.05.2006	NT425778





## Schedule of notices of leases continued

	Registration date and plan ref.	Property description	Date of lease and term	Lessee's title
47	26.10.2006 98 and 99	Apartment 38 (second floor) and parking space (basement level)	18.08.2006 999 years from 01.05.2006	NT425796
48	27.10.2006 100 and 101	Apartment 30 (second floor) and parking space	02.08.2006 999 years from 01.06.2005	NT425826
49	27.10.2006 102 and 103	Apartment 19 (first floor) and parking space	01.08.2006 999 years from 01.06.2005	NT425827
50	27.10.2006 104 and 105	Apartment 31 (second floor) and parking space	01.08.2006 999 years from 01.06.2005	NT425828
51	27.10.2006 106 and 107	Apartment 41 (third floor) and parking space (basement parking level)	02.08.2006 999 years from 01.06.2005	NT425829
52	27.10.2006 108 and 109	Apartment 42 (third floor apartment) and parking space (basement level)	04.08.2006 999 years from 01.06.2005	NT425830
53	27.10.2006 110 and 111	Apartment 72 (fifth floor) and parking space	14.08.2006 999 years from 01.06.2005	NT425832
54	27.10.2006 112	Apartment 7 (basement level) and garage	16.08.2006 999 years from 01.06.2005	NT425833
55	23.11.2006 113 and 114	Apartment 71 (fifth floor) and parking space	18.08.2006 999 years from 01.06.2005	NT426695
56	27.11.2006 115 and 116	Apartment 18 (first floor) and parking space (basement level)	28.07.2006 999 years from 1.6.2005	NT426830
57	28.11.2006 117 and 118	Apartment 10 (ground floor) and parking space (basement level)	30.08.2006 999 yers from 1.6.2005	NT426935
58	28.11.2006 119 and 120	Apartment 50 (third floor) and parking space (basement level)	31.08.2006 999 years from 1.6.2005	NT426936
59	29.11.2006 121 and 122	Apartment 62 (fifth floor) and parking space (lower level)	28.07.2006 999 years from 1.6.2005	NT426994
60	30.11.2006 123 and 124	Apartment 9 (ground floor) and parking space (basement level)	18.09.2006 999 years from 1.6.2005	NT427037
61	30.11.2006 125 and 126	Apartment 61 (fourth floor) and parking space (lower level)	22.08.2006 999 years from 1.6.2005	NT427038



## Schedule of notices of leases continued

	Registration date and plan ref.	Property description	Date of lease and term	Lessee's title
62	30.11.2006 127 and 128	Apartment 53 (fourth floor) and parking space (basement level)	30.08.2006 999 years from 1.6.2005	NT427039
63	30.11.2006 129 and 130	Apartment 12 (ground floor) and parking space (basement level)	14.08.2006 999 years from 1.6.2005	NT427040
64	06.12.2006 131 and 132	Apartment 11 (ground floor) and parking space (basement level)	16.08.2006 999 years from 1.6.2005	NT427257
65	07.12.2006 133 and 134	Apartment 15 (ground floor) and parking space (basement level)	21.08.2006 999 years from 1.6.2005	NT427297
66	08.12.2005 135 and 136	Apartment 43 (third floor) and parking space (basement parking level)	18.07.2006 999 years from 1.6.2005	NT427346
67	01.02.2007 137 and 138	Apartment 51 (fourth floor) and parking space	31.07.2006 999 years from 01.06.2005	NT429225
68	01.02.2007 139 and 140	Apartment 40 (third floor) and parking space (basement level)	31.07.2006 999 years from 01.06.2005	NT429229
69	13.03.2007 141 and 142	Apartment 1 and car parking space (basement level)	02.02.2007 999 years from 1.6.2005	NT430624
70	19.04.2007 143 and 144	Apartment 32 (second floor) and parking space	14.07.2006 999 years from 1.6.2005	NT431801
71	09.05.2007 145 and 146	Apartment 2 and car parking space (basement level)	05.02.2007 999 years from 1.6.2005	NT432460
72	25.07.2007 147 and 148	Apartment 4 (basement level) and garage	14.07.2006 999 years from 1.6.2005	NT434983
73	31.07.2007 149 and 150	Apartment 73 (sixth floor) and garage	25.07.2007 999 years from 1.6.2005	NT435173
74	31.07.2007 151 and 152	Apartment 74 (sixth floor) and garage	25.07.2007 999 years from 1.6.2005	NT435179
75	31.07.2007 153 and 154	Apartment 75 (sixth floor) and garage	25.07.2007 999 years from 1.6.2005	NT435182



## Schedule of notices of leases continued

	Registration date and plan ref.	Property description	Date of lease and term	Lessee's title
76	31.07.2007 155 and 156	Apartment 76 (sixth floor) and garage	25.07.2007 999 years from 1.6.2005	NT435183
77	31.07.2007 157 and 158	Apartment 77 (sixth floor) and garage	25.07.2007 999 years from 1.6.2005	NT435184
78	14.08.2018 159	Cell Site NOT0072 (Rooftop level)	10.08.2018 15 years beginning on and including 19 December 2012 and expiring on and including 18 December 2027	NT540683

NOTE: See entry in the Charges Register relating to the rights granted by this lease.

End of register

# HM Land Registry Official copy of title plan

Title number **NT396791**  
Ordnance Survey map reference **SK5741NE**  
Scale **1:1250**  
Administrative area **City of Nottingham**

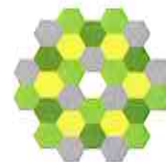

© Crown Copyright. Produced by HM Land Registry. Reproduction in whole or in part is prohibited without the prior written permission of Ordnance Survey. Licence Number 100026316.

See supplementary plans no.s 1 to 10.

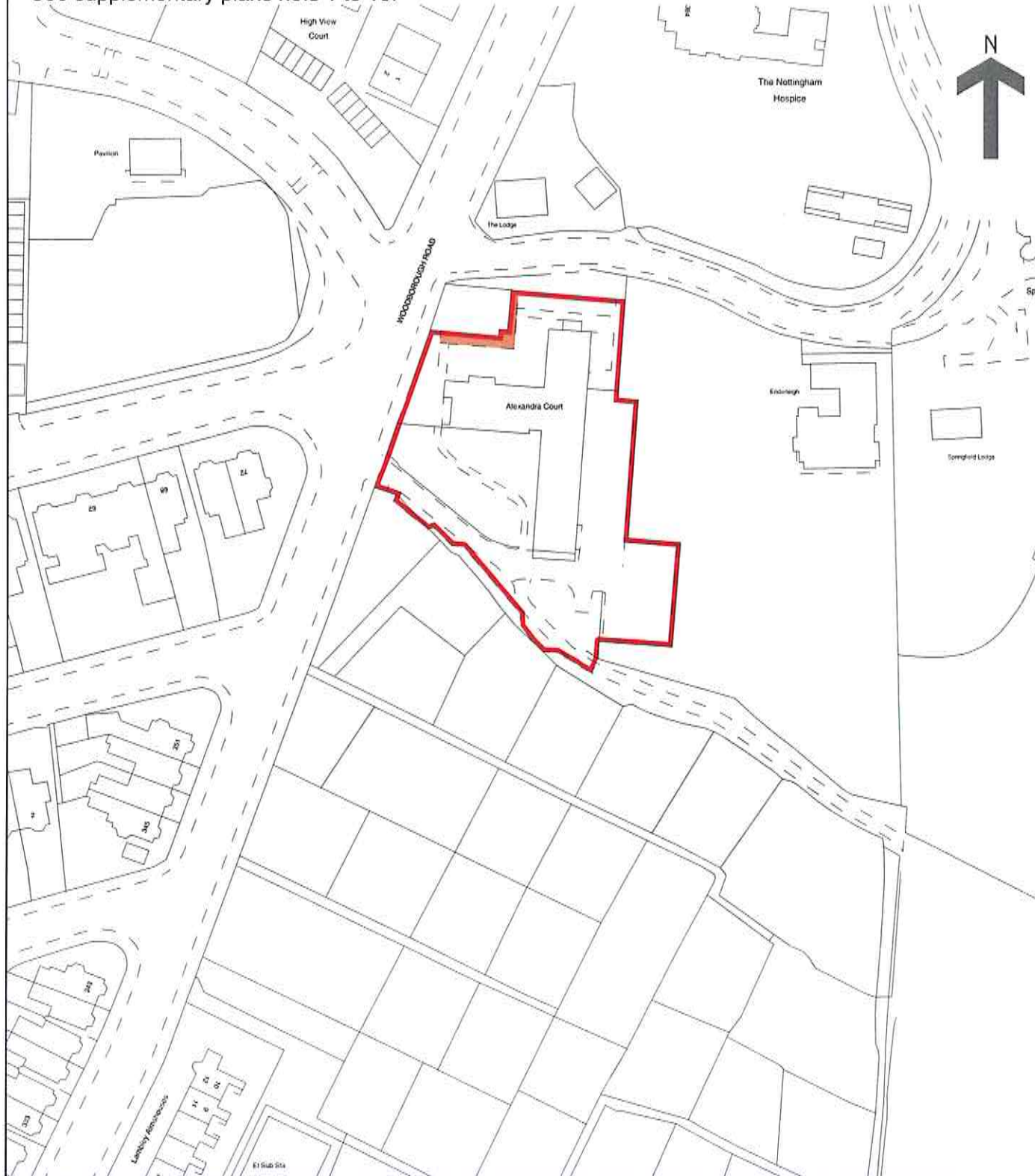

**This official copy issued on 21 January 2022 shows the state of this title plan on 20 January 2022 at 18:34:36.**

It is admissible in evidence to the same extent as the original (s.67 Land Registration Act 2002).

This title plan shows the general position, not the exact line, of the boundaries. It may be subject to distortions in scale. Measurements scaled from this plan may not match measurements between the same points on the ground.

**This title is dealt with by HM Land Registry, Durham Office.**



0658001016



# HM Land Registry Supplementary plan

Title number **NT396791**  
Ordnance Survey map reference **SK5741NE**  
Scale **1:500** enlarged from 1:1250  
Administrative area **City of Nottingham**

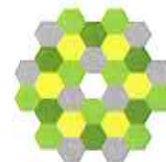

© Crown Copyright. Produced by HM Land Registry. Reproduction in whole or in part is prohibited without the prior written permission of Ordnance Survey. Licence Number 100026316.  
Supplementary plan no.1.

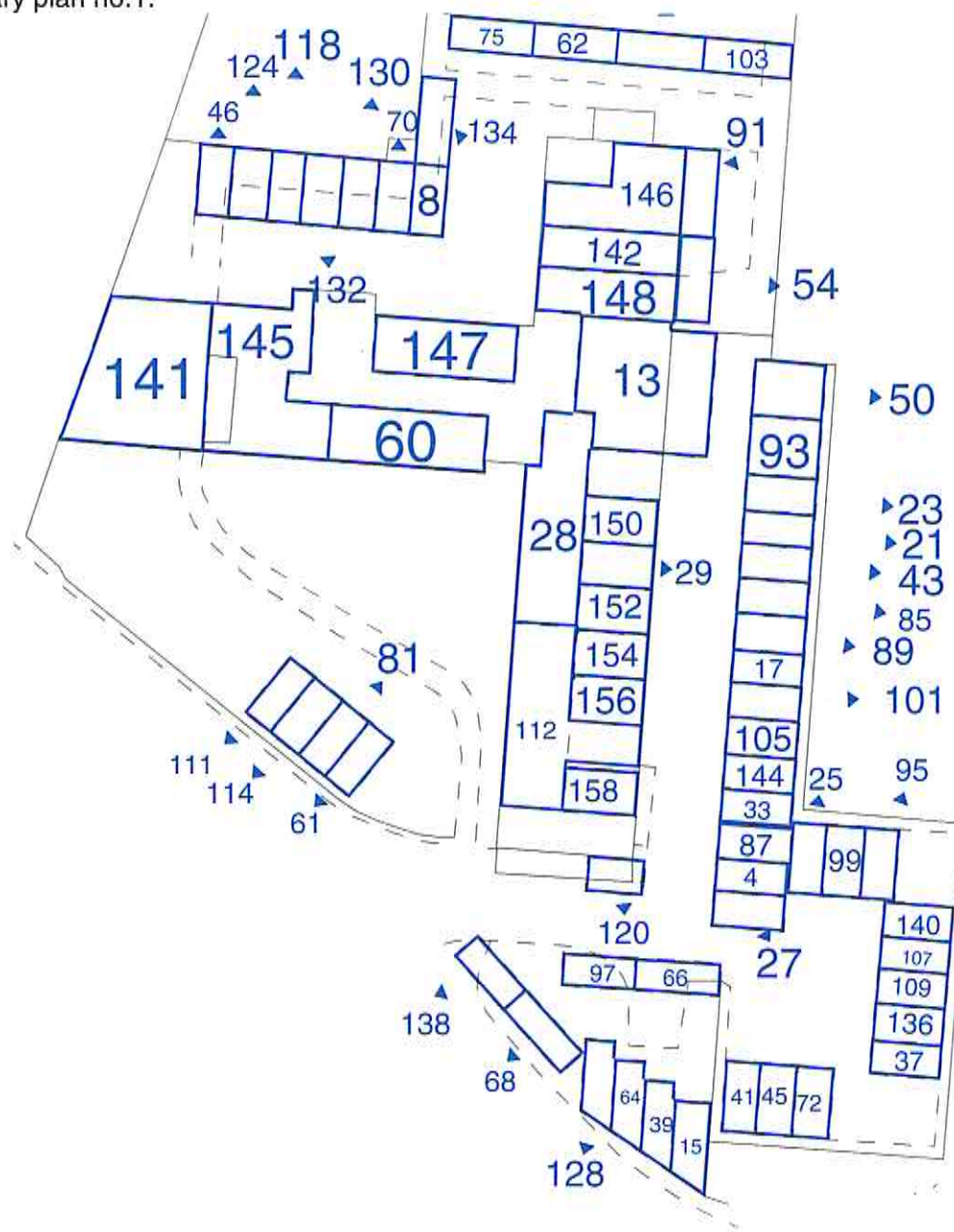

## Basement Level

This plan shows the general position, not the exact line, of the boundaries. It may be subject to distortions in scale. Measurements scaled from this plan may not match measurements between the same points on the ground.

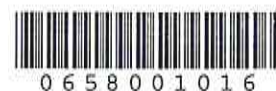

0658001016

# HM Land Registry Supplementary plan

Title number **NT396791**  
Ordnance Survey map reference **SK5741NE**  
Scale **1:500** enlarged from 1:1250  
Administrative area **City of Nottingham**

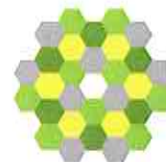

© Crown Copyright. Produced by HM Land Registry. Reproduction in whole or in part is prohibited without the prior written permission of Ordnance Survey. Licence Number 100026316.  
Supplementary plan no.2.

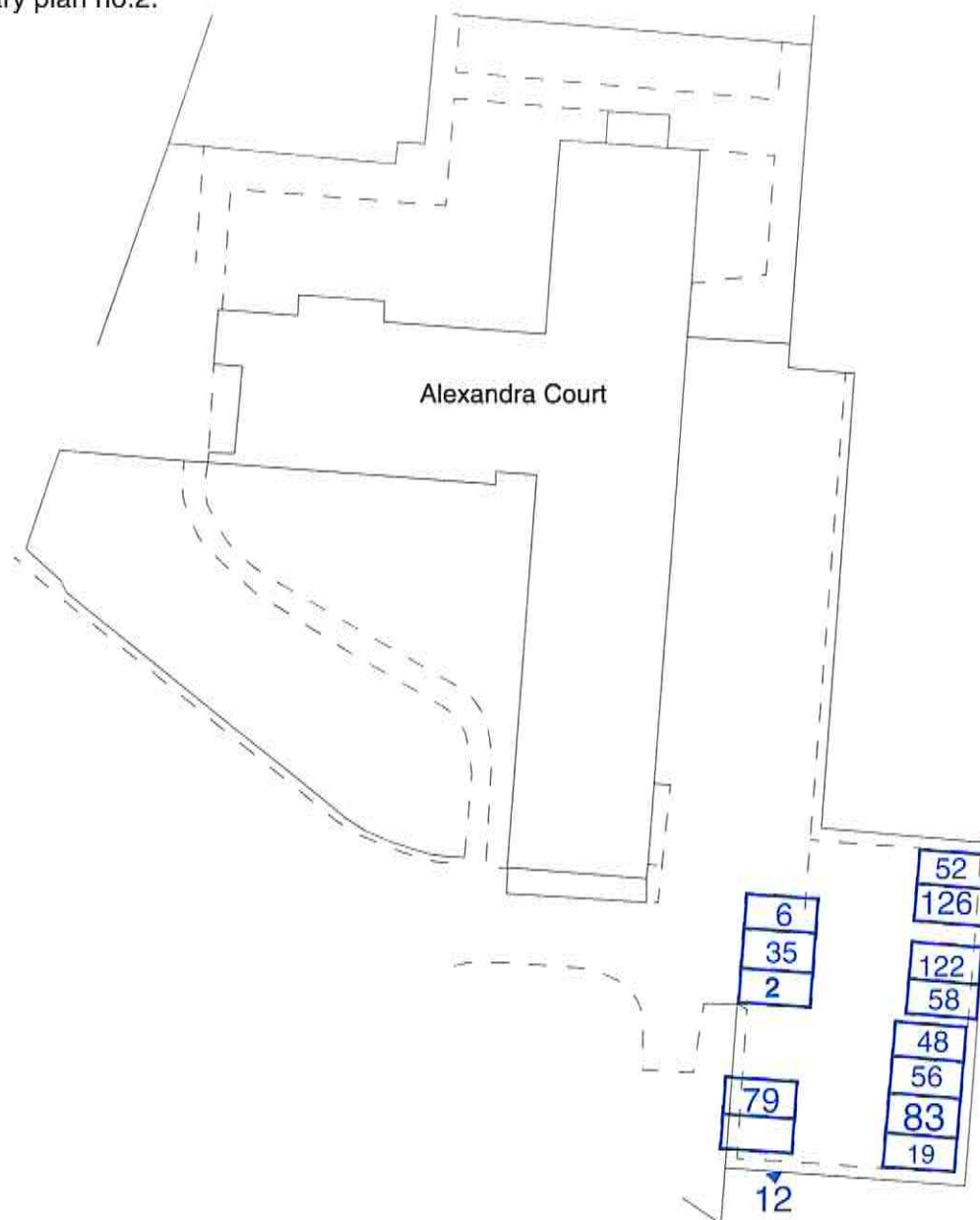

## Lower Parking Level

This plan shows the general position, not the exact line, of the boundaries. It may be subject to distortions in scale. Measurements scaled from this plan may not match measurements between the same points on the ground.

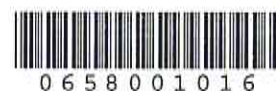

0658001016

# HM Land Registry Supplementary plan

Title number **NT396791**  
Ordnance Survey map reference **SK5741NE**  
Scale **1:500** enlarged from 1:1250  
Administrative area **City of Nottingham**

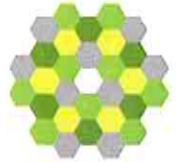

© Crown Copyright. Produced by HM Land Registry. Reproduction in whole or in part is prohibited without the prior written permission of Ordnance Survey. Licence Number 100026316.  
Supplementary plan no.3.

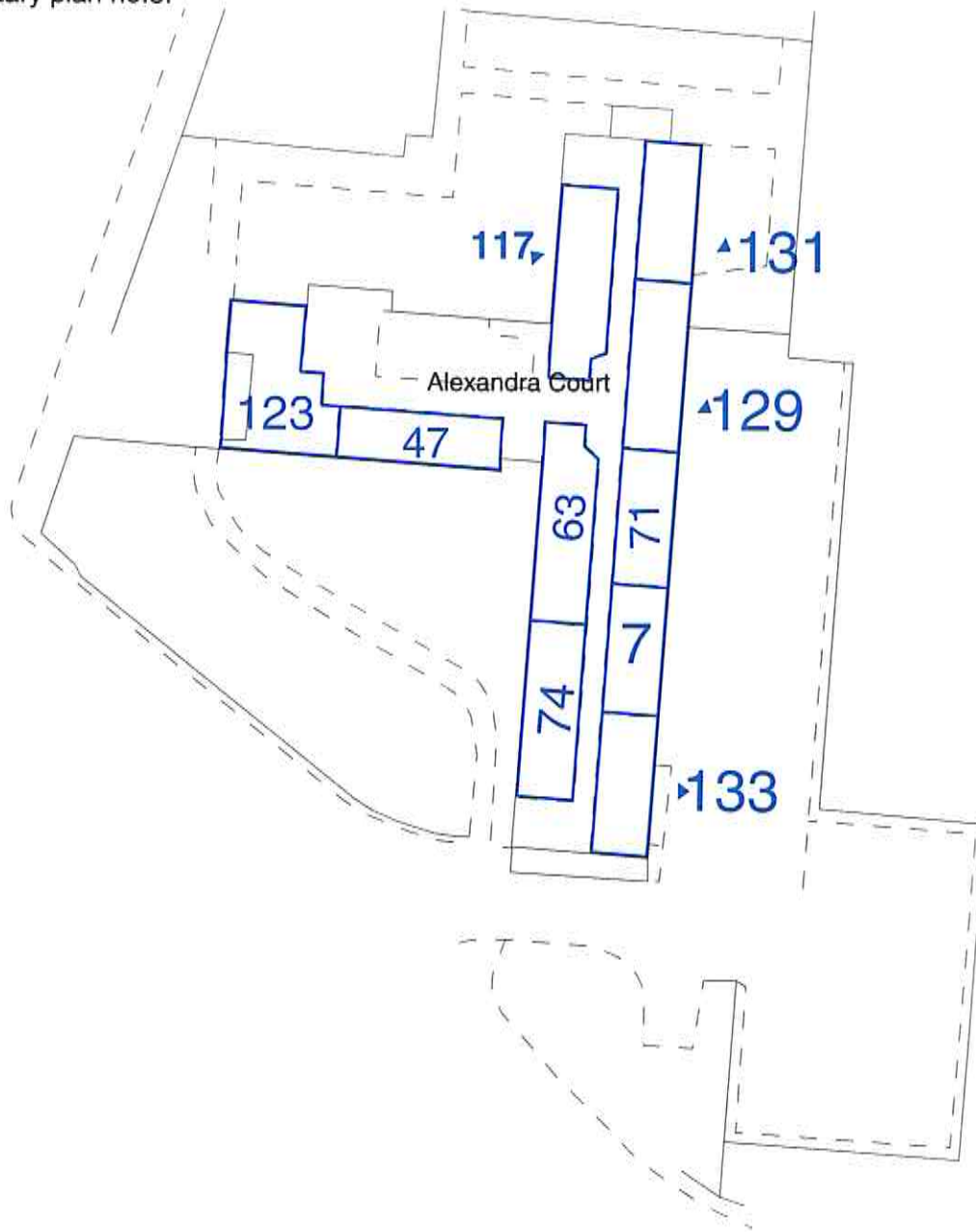

## Ground Floor

This plan shows the general position, not the exact line, of the boundaries. It may be subject to distortions in scale. Measurements scaled from this plan may not match measurements between the same points on the ground.

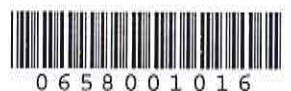



# HM Land Registry Supplementary plan

Title number **NT396791**  
Ordnance Survey map reference **SK5741NE**  
Scale **1:500** enlarged from 1:1250  
Administrative area **City of Nottingham**

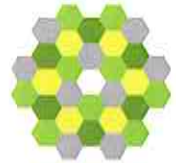

© Crown Copyright. Produced by HM Land Registry. Reproduction in whole or in part is prohibited without the prior written permission of Ordnance Survey. Licence Number 100026316.  
Supplementary plan no.4.

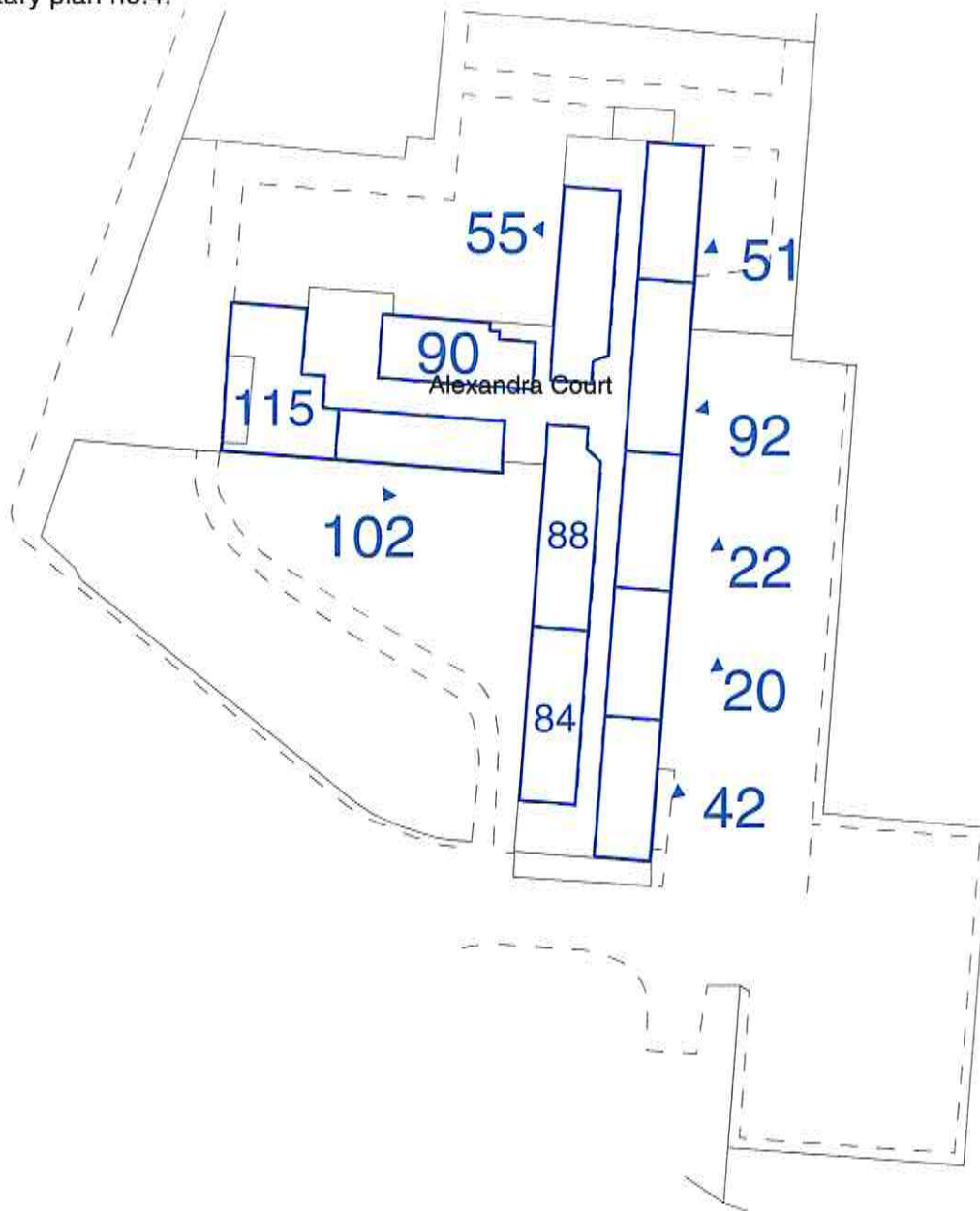

**First Floor**

This plan shows the general position, not the exact line, of the boundaries. It may be subject to distortions in scale. Measurements scaled from this plan may not match measurements between the same points on the ground.

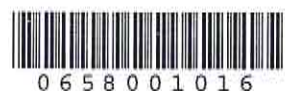

0658001016

# HM Land Registry Supplementary plan

Title number **NT396791**  
Ordnance Survey map reference **SK5741NE**  
Scale **1:500** enlarged from 1:1250  
Administrative area **City of Nottingham**



© Crown Copyright. Produced by HM Land Registry. Reproduction in whole or in part is prohibited without the prior written permission of Ordnance Survey. Licence Number 100026316.  
Supplementary plan no.5.

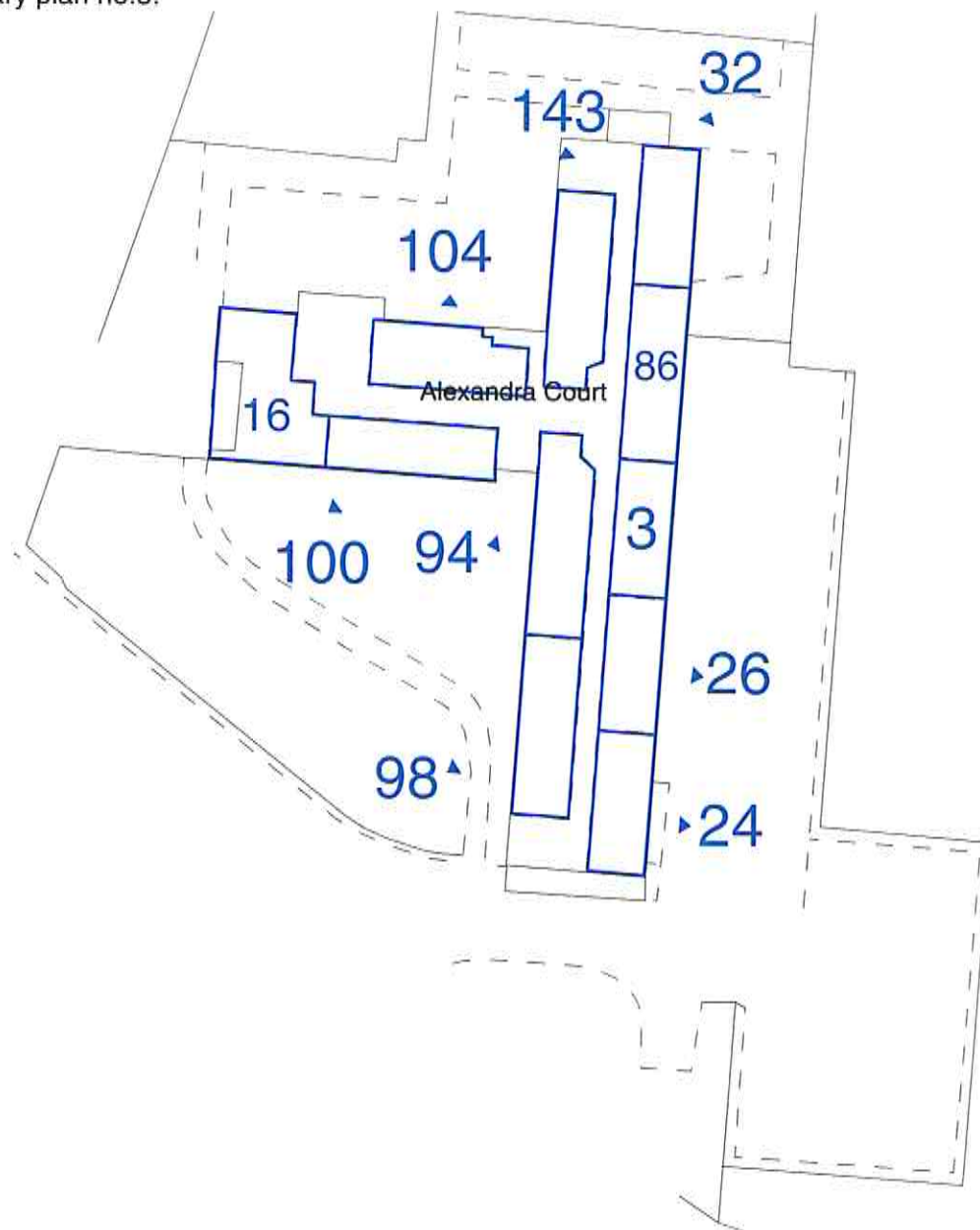

**Second Floor**

This plan shows the general position, not the exact line, of the boundaries. It may be subject to distortions in scale. Measurements scaled from this plan may not match measurements between the same points on the ground.

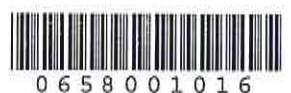

# HM Land Registry Supplementary plan

Title number **NT396791**  
Ordnance Survey map reference **SK5741NE**  
Scale **1:500** enlarged from 1:1250  
Administrative area **City of Nottingham**

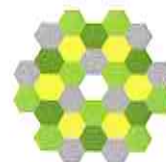

© Crown Copyright. Produced by HM Land Registry. Reproduction in whole or in part is prohibited without the prior written permission of Ordnance Survey. Licence Number 100026316.  
Supplementary plan no.6.

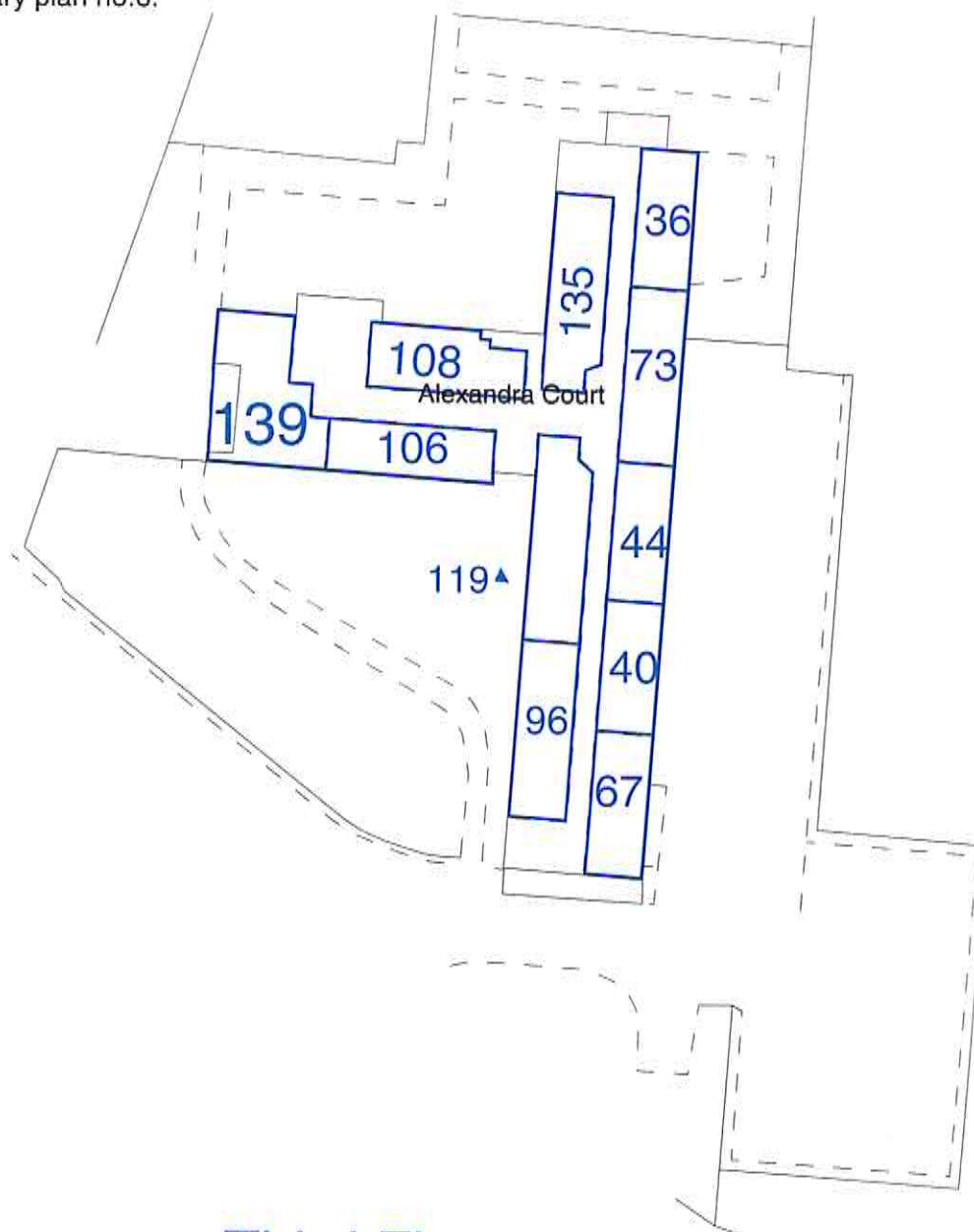

**Third Floor**

This plan shows the general position, not the exact line, of the boundaries. It may be subject to distortions in scale. Measurements scaled from this plan may not match measurements between the same points on the ground.

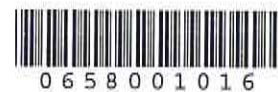



# HM Land Registry Supplementary plan

Title number **NT396791**  
Ordnance Survey map reference **SK5741NE**  
Scale **1:500** enlarged from 1:1250  
Administrative area **City of Nottingham**



© Crown Copyright. Produced by HM Land Registry. Reproduction in whole or in part is prohibited without the prior written permission of Ordnance Survey. Licence Number 100026316.  
Supplementary plan no.7.

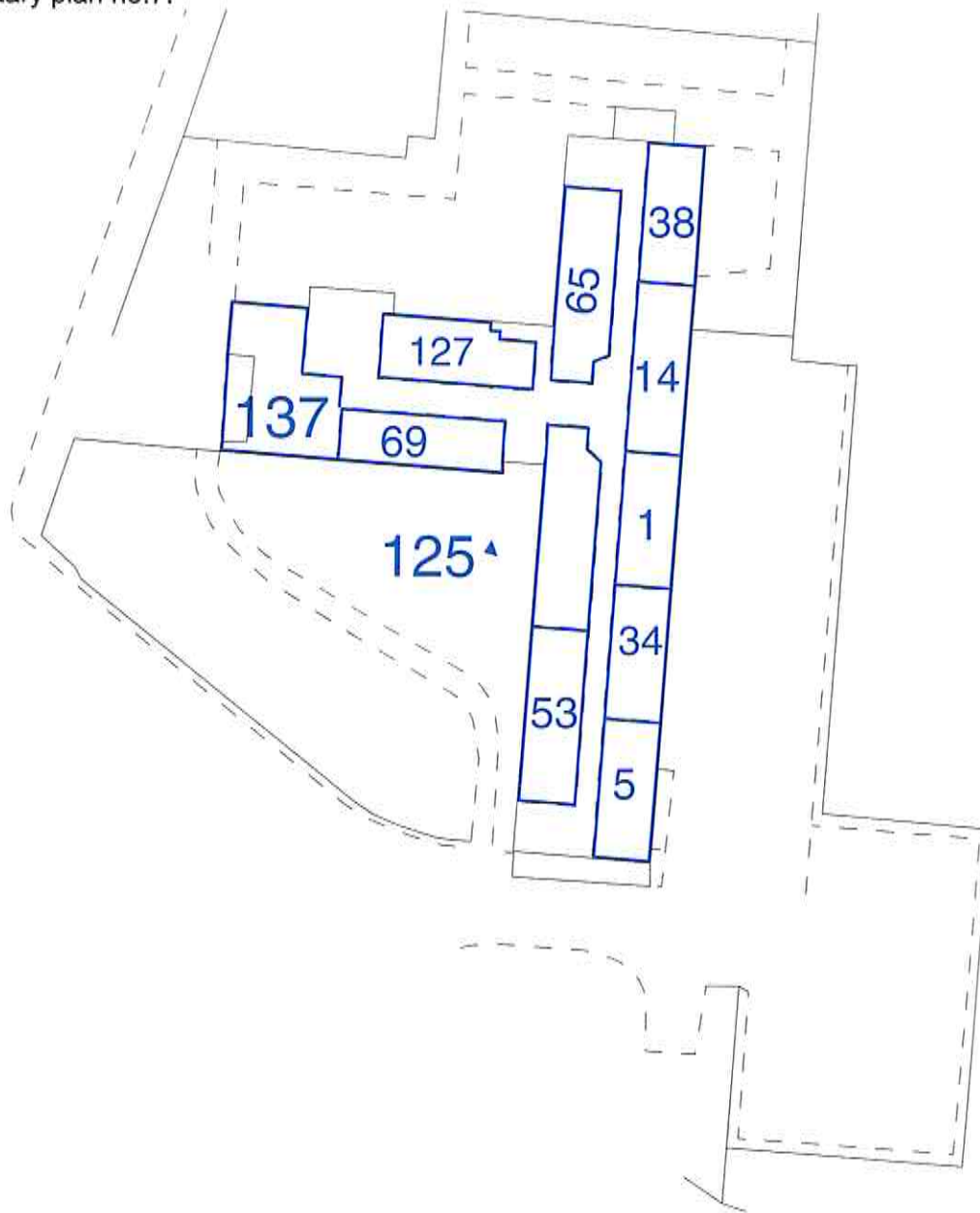

## Fourth Floor

This plan shows the general position, not the exact line, of the boundaries. It may be subject to distortions in scale. Measurements scaled from this plan may not match measurements between the same points on the ground.

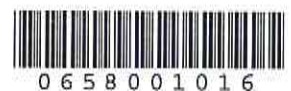

0 6 5 8 0 0 1 0 1 6

# HM Land Registry Supplementary plan

Title number **NT396791**  
Ordnance Survey map reference **SK5741NE**  
Scale **1:500** enlarged from 1:1250  
Administrative area **City of Nottingham**

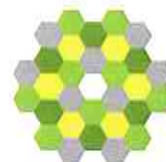

© Crown Copyright. Produced by HM Land Registry. Reproduction in whole or in part is prohibited without the prior written permission of Ordnance Survey, Licence Number 100026316.  
Supplementary plan no.8.

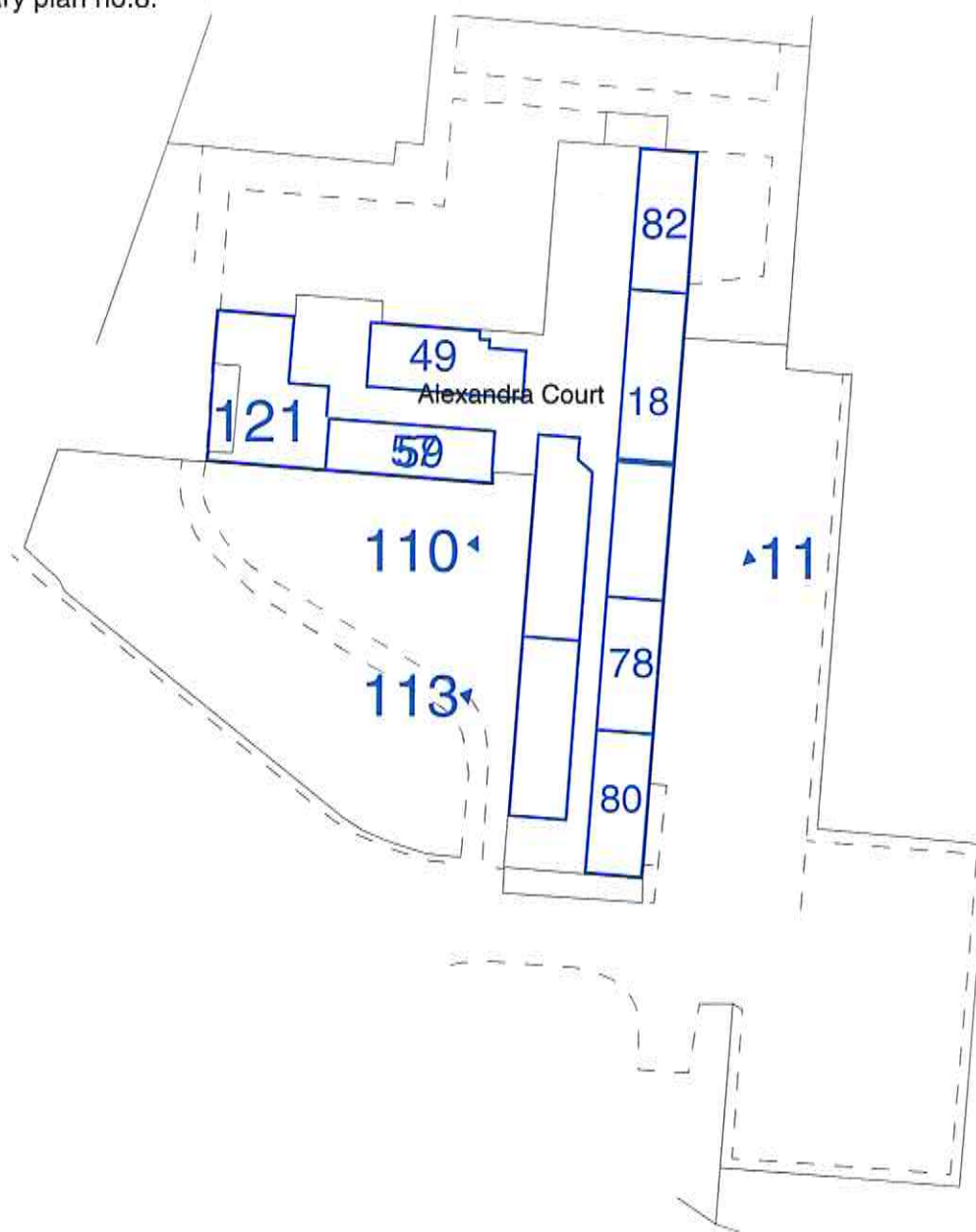

**Fifth Floor**

This plan shows the general position, not the exact line, of the boundaries. It may be subject to distortions in scale. Measurements scaled from this plan may not match measurements between the same points on the ground.

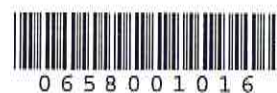

# HM Land Registry Supplementary plan

Title number **NT396791**  
Ordnance Survey map reference **SK5741NE**  
Scale **1:500** enlarged from 1:1250  
Administrative area **City of Nottingham**

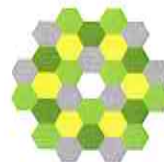

© Crown Copyright. Produced by HM Land Registry. Reproduction in whole or in part is prohibited without the prior written permission of Ordnance Survey. Licence Number 100026316.  
Supplementary plan no.9.

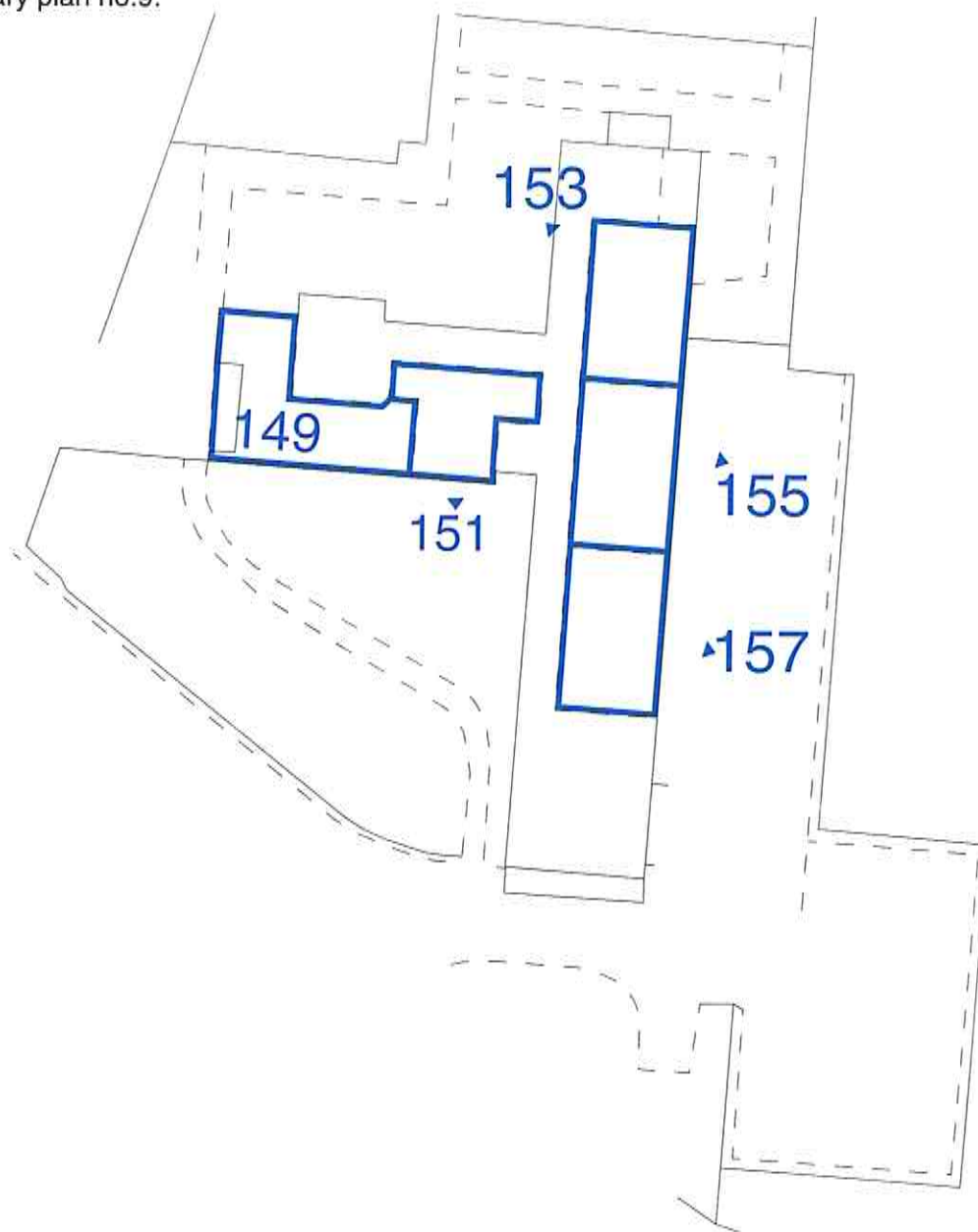

**Sixth Floor**

This plan shows the general position, not the exact line, of the boundaries. It may be subject to distortions in scale. Measurements scaled from this plan may not match measurements between the same points on the ground.

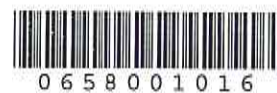

0658001016



# HM Land Registry Supplementary plan

Title number **NT396791**  
Ordnance Survey map reference **SK5741NE**  
Scale **1:500** enlarged from 1:1250  
Administrative area **City of Nottingham**

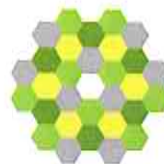

© Crown Copyright. Produced by HM Land Registry. Reproduction in whole or in part is prohibited without the prior written permission of Ordnance Survey. Licence Number 100026316.  
Supplementary plan no.10.

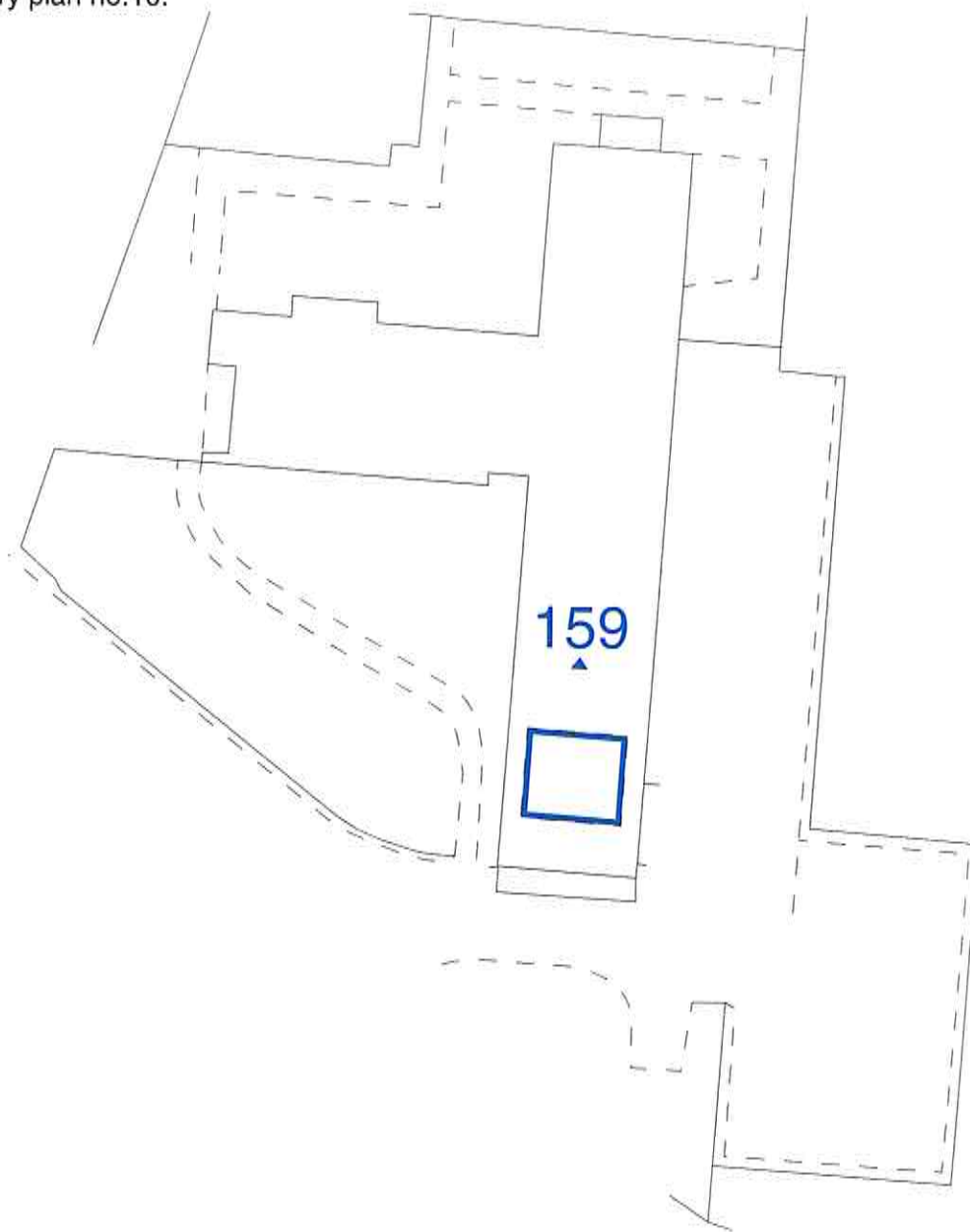

## Rooftop Level

This plan shows the general position, not the exact line, of the boundaries. It may be subject to distortions in scale. Measurements scaled from this plan may not match measurements between the same points on the ground.

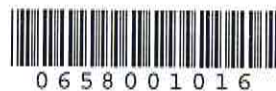

0658001016